

FORGED BRASS BALL VALVES

5/8" TO 2-5/8" ODS WITH EXPANDED COPPER TUBE EXTENSIONS
AND OPTIONAL PURGE PORTS

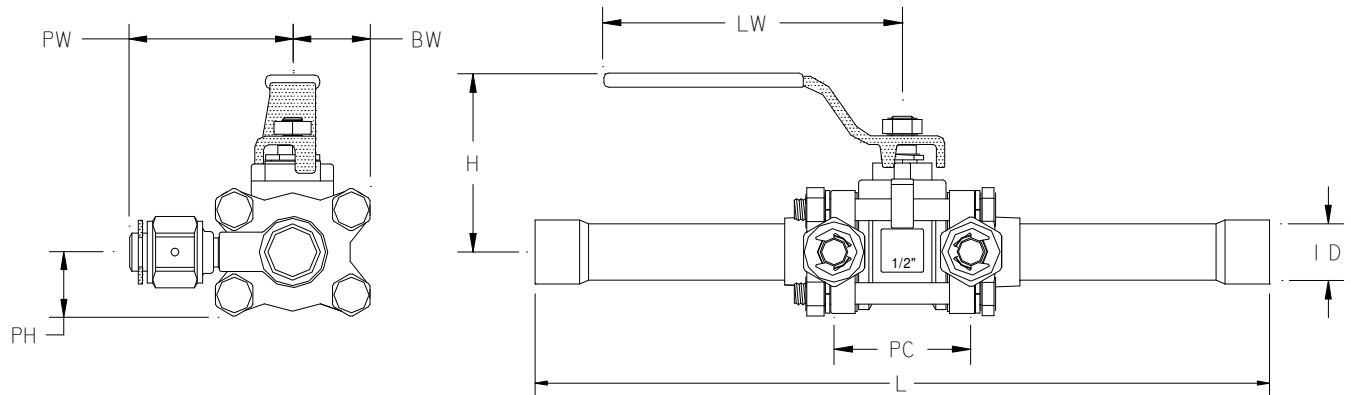

FORGED BRASS BALL VALVES WITH EXPANDED COPPER TUBE EXTENSIONS

PART NUMBER	ID	PW	BW	PH	PC	LW	H	L	WT
W0625	0.625	1.918	0.918	0.682	1.750	3.375	1.875	8.250	1.2
W0875	0.875	2.000	1.000	1.000	2.125	4.500	2.250	10.250	2.0
W1125	1.125	2.093	1.093	1.093	2.375	4.500	2.375	13.500	2.6
W1375	1.375	2.320	1.320	1.320	2.125	5.250	3.000	17.750	4.4
W1625	1.625	2.500	1.500	1.500	2.362	5.250	3.250	18.250	5.8
W2125	2.125	2.915	1.915	1.915	3.083	6.375	3.875	18.750	11.6
W2625	2.625	3.965	2.965	2.965	3.612	9.000	4.250	19.750	14.0

NOTE: THE VALVE INTERNALS ARE NOT TO BE REMOVED PRIOR TO INERT GAS PURGE INSTALLATION.

ALL PRODUCTS ARE HELIUM LEAK TESTED TO 4.5×10^{-6} std cm³/s

DANCAR CORPORATION - 145 N. Benson Road, Middlebury, CT 06762
Tel. (203) 598-0205 - Fax (203) 598-0211

dancar@dancar.com